



- Ball Valve
- Gate Valve
- Globe Valve
- Check Valve
- Forged Valve
- Butterfly Valve



LEAD VALVE (UK) LTD

7-11 Minerva Road Park Royal London United Kingdom NW 10 6HJ
www.leadvalve.co.uk
Tel: (+44) 2038684477
Email: sales@leadvalve.com

LEAD

LEAD VALVE (UK) LTD

FORGED VALVE DATA SHEET

Special Purposes Gate Valve

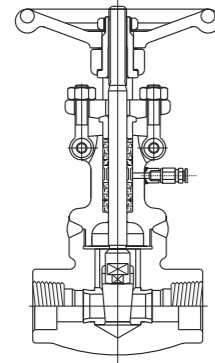

- Welded bonnet
- Os & y
- Packing
- Distance ring
- Grease valve
- Solid wedge

Vacuum gate valves

CLASS800 API602 BS5352	Temperature pressure 1975 psi @ 100°F	materials		
		body/bonnet	trim	bolt
		Carbon steel	13Cr	B7

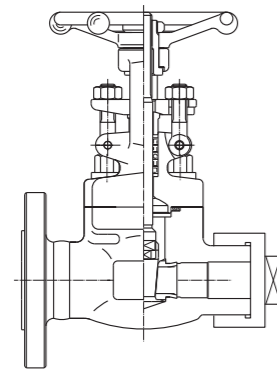

- Welded bonnet
- Os & y
- cap fitting connection
- Solid wedge

For venting and /or releasing media

CLASS800 API602 BS5352	Temperature pressure 1975 psi @ 100°F	materials		
		body/bonnet	trim	bolt
		Carbon steel	13Cr	B7

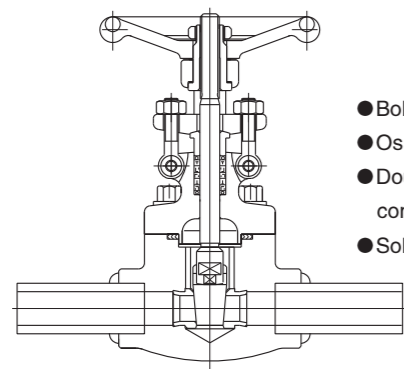

- Bolted bonnet
- Os & y
- Double end pipe connection
- Solid wedge

Coupling pipe valves

CLASS800 API602 BS5352	Temperature pressure 1975 psi @ 100°F	materials		
		body/bonnet	trim	bolt
		Carbon steel	13Cr	B7

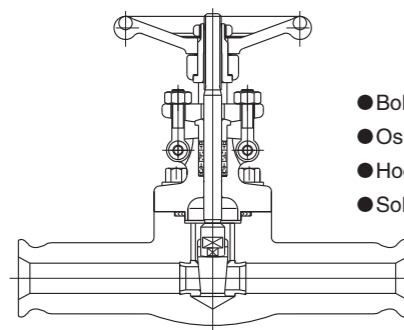

- Bolted bonnet
- Os & y
- Hoop connection
- Solid wedge

Hoop gate valves

CLASS800 API602 BS5352	Temperature pressure 1975 psi @ 100°F	materials		
		body/bonnet	trim	bolt
		Carbon steel	13Cr	B7

Y Type Check Valve CL2500-4500

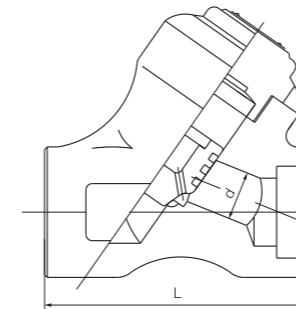

CL2500

Welded bonnet, full port
 Threaded, butt-welded or socket welded ends; design to ASME B16.34

NPS	F.P	3/8	1/2	3/4	1	1 1/4	1 1/2	2
L		186	186	186	186	232	232	310
D		9	11	14	19	25	28	35

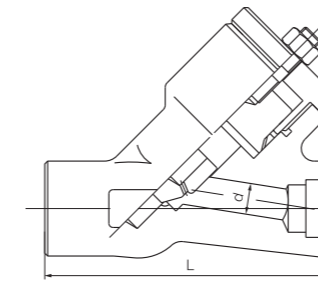

CL2500

Pressure seal, bolted bonnet, full port
 Threaded, butt-welded or socket welded ends; design to ASME B16.34

NPS	F.P	3/8	1/2	3/4	1	1 1/4	1 1/2	2
L		186	186	186	186	232	232	310
D		9	11	14	19	25	28	35

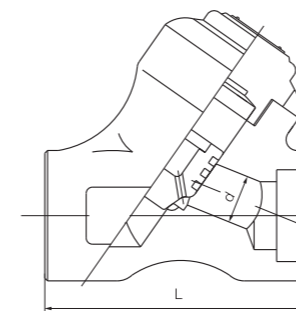

CL4500

Welded bonnet, full port
 Threaded, butt-welded or socket welded ends; design to ASME B16.34

NPS	F.P	3/8	1/2	3/4	1	1 1/4	1 1/2	2
L		156	155	155	155		225	225
D		9	11	11	15		26	28

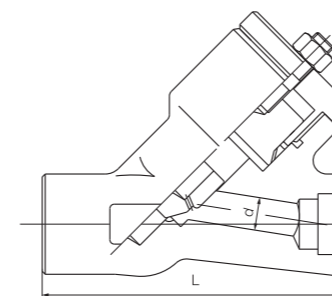

CL4500

Pressure seal, bolted bonnet, full port
 Threaded, butt-welded or socket welded ends; design to ASME B16.34

NPS	F.P	3/8	1/2	3/4	1	1 1/4	1 1/2	2
L		200	200	200	200	250	250	330
D		9	11	11	15	20	26	28

Y Type Check Valve CL800-1500

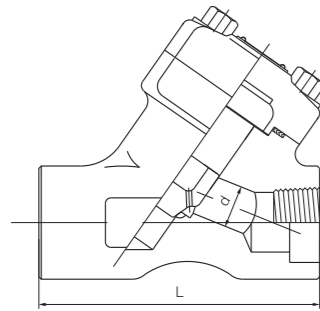

CL800

Bolted bonnet, full port and reducing port
Threaded, butt-welded or socket welded ends; design to BS5352

NPS	R.P	-	1/2	3/4	1	1 1/4	1 1/2	2	2 1/2	3
	F.P	1/4	3/8	1/2	3/4	1	1 1/4	1 1/2	2	2 1/2
L		98	98	96	111	140	140	155	170	-
D		7	10	13	17.5	23	30	35	46	-

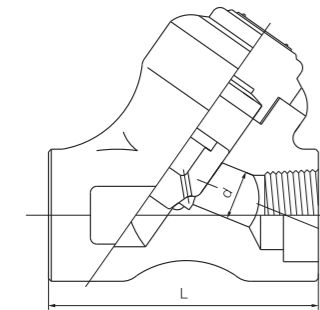

CL800

Welded bonnet, full port and reducing port
Threaded, butt-welded or socket welded ends; design to BS5352

NPS	R.P	-	1/2	3/4	1	1 1/4	1 1/2	2	2 1/2	3
	F.P	1/4	3/8	1/2	3/4	1	1 1/4	1 1/2	2	2 1/2
L		79	79	92	100	140	140	155	170	-
D		7	10	13	17.5	23	30	35	46	-

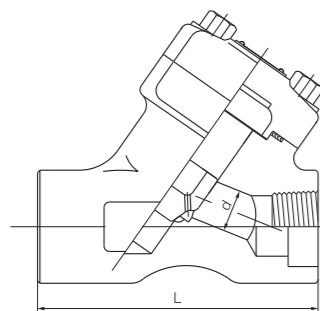

CL900-CL1500

Bolted bonnet, full port
Threaded, butt-welded or socket welded ends; design to BS5352

NPS	F.P	3/8	1/2	3/4	1	1 1/4	1 1/2	2	2 1/2
	L		98	111	111	140	140	155	170
D		9	12	15	20	28	32	40	-

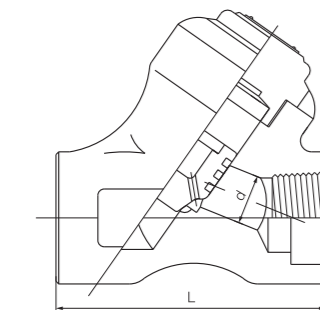

CL900-CL1500

Welded bonnet, full port
Threaded, butt-welded or socket welded ends; design to BS5352

NPS	F.P	3/8	1/2	3/4	1	1 1/4	1 1/2	2	2 1/2
	L		92	100	100	140	140	155	170
D		9	12	15	20	32	28	40	-

Bellow Sealed Gate Valve CL800-1500

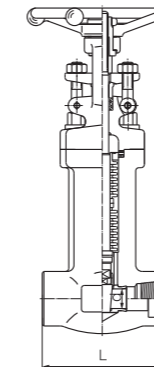

CL800

Bolted bonnet, full port & reducing port outside screw and yoke (OS & Y)
Threaded, butt-welded or socket welded ends; design to API602MSS-SP-117

NPS	R.P	-	1/2	3/4	1	1 1/4	1 1/2	2
	F.P	1/4	3/8	1/2	3/4	1	1 1/4	1 1/2
L		79	79	92	111	120	160	140
D		7.5	10.5	13.5	18	24	29	36.5

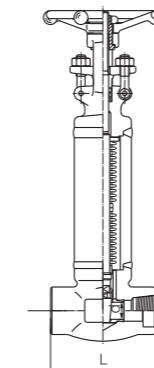

CL800

Welded bonnet, full port & reducing port outside screw and yoke (OS & Y)
Threaded, butt-welded or socket welded ends; design to API602MSS-SP-117

NPS	R.P	-	1/2	3/4	1	1 1/4	1 1/2	2
	F.P	1/4	3/8	1/2	3/4	1	1 1/4	1 1/2
L		79	79	92	111	120	160	140
D		7.5	10.5	13.5	18	24	29	36.5

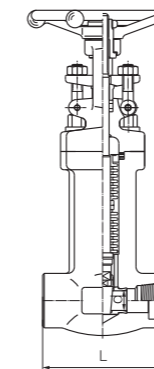

CL1500

Bolted bonnet, full port & reducing port outside screw and yoke (OS & Y)
Threaded, butt-welded or socket welded ends; design to API602MSS-SP-117

NPS	R.P	-	1/2	3/4	1	1 1/4	1 1/2	2
	F.P	1/4	3/8	1/2	3/4	1	1 1/4	1 1/2
L		79	111	111	120	120	140	178
D		7.5	10.5	13.5	18	24	29	36.5

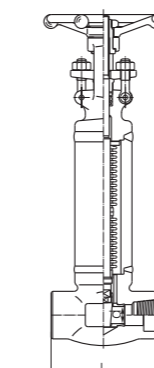

CL1500

Welded bonnet, full port & reducing port outside screw and yoke (OS & Y)
Threaded, butt-welded or socket welded ends; design to API602MSS-SP-117

NPS	R.P	-	1/2	3/4	1	1 1/4	1 1/2	2
	F.P	1/4	3/8	1/2	3/4	1	1 1/4	1 1/2
L		79	111	111	120	120	140	178
D		7.5	10.5	13.5	18	24	29	36.5

Cryogenic Gate Valve CL150-800

Applicable standards:

- Design and manufacture conform to :API 602 Bs5352 ANSI B16.34
- Connection ends conform to :
 - 1)Socket welded dimension conform ANSI B16.11
 - 2)Screw ends dimension conform to ANSI B1.20.1
 - 3)Butt-welded conform to ANSI B16.25
 - 4)Flanged ends conform to ANSI B16.5
- Test and inspection conform to :API 598
- Structure features:
 - Bolted bonnet,outside screw and yoke
 - welded bonnet,outside screw and yoke
- Materials conform to ANSI/ASTM
- Main materials:L:F2;LF3;304(L);316(L);F347;F321;F51

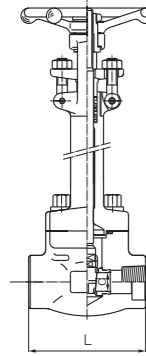

CL800

Bolted bonnet,cryogenic extended bonnet full port & reduced port,(OS & Y)
 Threaded,butt-welded or socket welded ends;design to API 602

NPS	R.P	-	1/2	3/4	1	1 1/4	1 1/2	2	2 1/2	3
	F.P	1/4	3/8	1/2	3/4	1	1 1/4	1 1/2	2	2 1/2
L		79	79	92	111	120	120	140	178	180
D		7.5	10.5	13.5	18	24	29	36.5	45	51

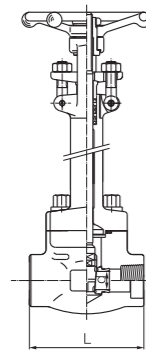

CL1500

Bolted bonnet,cryogenic extended bonnet full port & reduced port,(OS & Y)
 Threaded,butt-welded or socket welded ends;design to API 602

NPS	R.P	-	1/2	3/4	1	1 1/4	1 1/2	2	2 1/2
	F.P	1/4	3/8	1/2	3/4	1	1 1/4	1 1/2	2
L		79	111	111	120	120	140	178	180
D		7.5	10.5	13.5	18	24	29	36.5	45

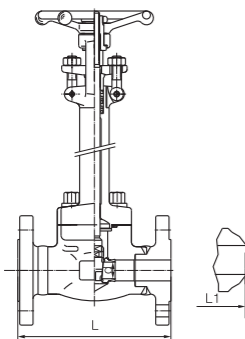

CL150-300-600

Bolted bonnet,cryogenic extended bonnet full reduced port,(OS & Y)
 Flanged or butt welded ends;design to API 602

NPS	F.P	1/4	3/8	1/2	3/4	1	1 1/4	1 1/2	2
		L(RF) L1(BW)	-	-	108	118	127	-	165
		-	-	140	153	165	-	191	216
		-	-	165	191	216	-	241	292
D		-	-	10.5	13.5	18	24	29	36.5

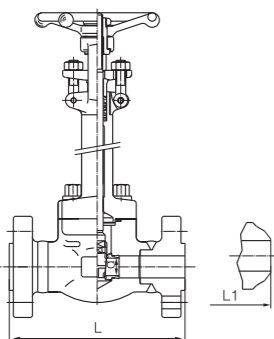

CL150-300-600

Bolted bonnet,cryogenic extended bonnet full port,(OS & Y)
 Flanged or butt welded ends;design to API 602

NPS	R.P	-	1/2	3/4	1	1 1/4	1 1/2	2
L			216	229	254	279	325	368
D			10.5	13.5	18	24	29	36.5

Flange Integrity forged steel valve enquiry please contact sales department.

Flange and Butt- Welded Check Valve CL900-2500

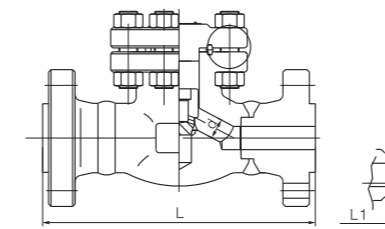

CL900-CL1500

Bolted bonnet,full port
 Flange-or butt-welded ends;design to BS5352

NPS	F.P	1/2	3/4	1	1 1/4	1 1/2	2
L(RF), L1(BW)		216	229	254	280	305	371
D	Lift	12	15	20	28	32	40
	swing	13.5	18	24	29	36.5	45

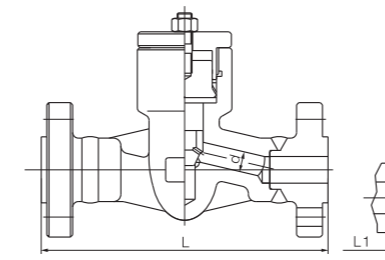

CL900-CL1500

Pressure seal,bolted bonnet,full port and reducing port
 Flange-or butt-welded ends;design to BS5352

NPS	F.P	3/8	1/2	3/4	1	1 1/4	1 1/2	2
L(RF), L1(BW)		-	216	229	254	280	305	268
L(RTJ)		-	216	229	254	280	305	371
D		-	12	28	20	28	32	40

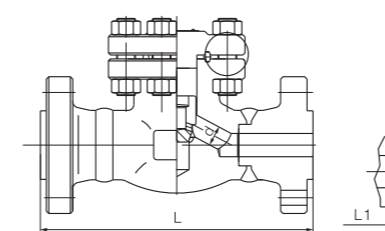

CL2500

Bolted bonnet,full port
 Flange-or butt-welded ends;design to ASME B16.34

NPS	F.P	1/2	3/4	1	1 1/4	1 1/2	2
L(RF), L1(BW)		264	273	308	349	384	450
L(RTJ)		264	273	308	352	387	454
D	Lift	12	15	20	28	32	40
	swing	10.5	13.5	18	24	29	36.5

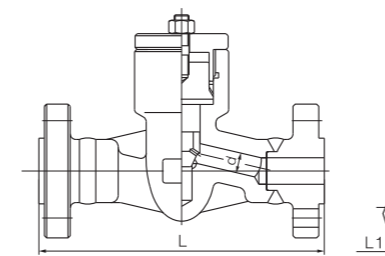

CL2500

Pressure seal,Bolted bonnet,full port
 Flange-or butt-welded ends;design to ASME B16.34

NPS	F.P	3/8	1/2	3/4	1	1 1/4	1 1/2	2
L(RF), L1(BW)		-	264	273	308	349	384	450
L(RTJ)		-	264	273	308	352	387	454
D		-	12	15	20	32	28	40

Flange and Butt-Welded Check Valve CL150-600

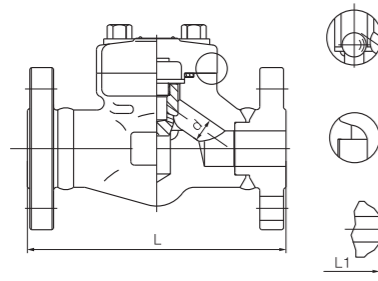

CL150-300-600 Bolted bonnet, reducing port
Flange-or butt-welded ends; design to BS5352

(NPS)	R.P	1/4	3/8	1/2	3/4	1	1 1/4	1 1/2	2
L(RF) L1(BW)	-	-	108	118	127	140	165	203	
	-	-	153	178	203	216	229	267	
	-	-	165	191	216	229	241	292	
D	-	-	10	13	17.5	23	30	35	

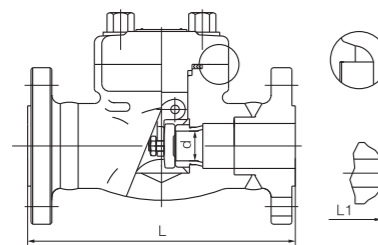

CL150-300-600 Bolted bonnet, reducing port
Flange-or butt-welded ends; design to BS5352

(NPS)	R.P	1/4	3/8	1/2	3/4	1	1 1/4	1 1/2	2
L(RF) L1(BW)	-	-	108	118	127	140	165	203	
	-	-	153	178	203	216	229	267	
	-	-	165	191	216	229	241	292	
D	-	-	10.5	13.5	18	24	29	36.5	

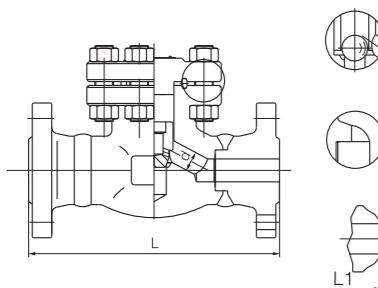

CL150-300-600 Bolted bonnet, reducing port
Flange-or butt-welded ends; design to BS5352

(NPS)	R.P	1/4	3/8	1/2	3/4	1	1 1/4	1 1/2	2
L(RF) L1(BW)	-	-	108	118	127	140	165	203	
	-	-	153	178	203	216	229	267	
	-	-	165	191	216	229	241	292	
D	-	-	10	13	17.5	23	30	35	

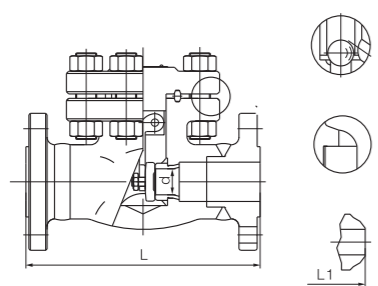

CL150-300-600 Bolted bonnet, reducing port
Flange-or butt-welded ends; design to BS5352

(NPS)	R.P	1/4	3/8	1/2	3/4	1	1 1/4	1 1/2	2
L(RF) L1(BW)	-	-	108	118	127	140	165	203	
	-	-	153	178	203	216	229	267	
	-	-	165	191	216	229	241	292	
D	-	-	10.5	13.5	18	24	29	36.5	

Female Threaded and Socket Welded Gate Valve CL800-1500

Applicable standards:

- Design and manufacture conform to :API602, BS5352, ANSI B16.34
- Connection ends conform to :
 - 1) Socket welded dimension conform ANSI B16.11
 - 2) Screw ends dimension conform to ANSI B1.20.1
 - 3) Butt-welded conform to ANSI B16.25
 - 4) Flanged ends conform to ANSI B16.5
- Test and inspection conform to :API 598
- Structure features:
 - Bolted bonnet, outside screw and yoke
 - Welded bonnet, outside screw and yoke
- Materials conform to ANSI/ASTM
- Main materials: A105, LF2, F5, F11, F22, 304(L), 316(L); F347, F321, F51, Monel, 20 Alloy.

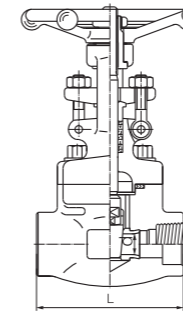

CL800 Bolted bonnet, full port & reducing port outside screw and yoke (os & Y)
threaded, butt-welded or socket welded ends; design to API 602

NPS	R.P	-	1/2	3/4	1	1 1/4	1 1/2	2	2 1/2	3
	F.P	1/4	3/8	1/2	3/4	1	1 1/4	1 1/2	2	2 1/2
L		79	79	92	111	120	120	140	178	180
D		8	10.5	13.5	18	24	29	36.5	45	51

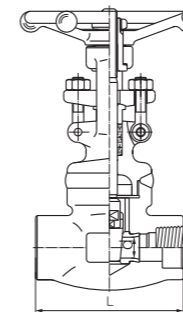

CL800 Welded bonnet, full port & reducing port outside screw and yoke (os & Y)
threaded, butt-welded or socket ends; design to API 602

NPS	R.P	-	1/2	3/4	1	1 1/4	1 1/2	2	2 1/2	3
	F.P	1/4	3/8	1/2	3/4	1	1 1/4	1 1/2	2	2 1/2
L		79	79	92	111	120	120	140	178	180
D		8	10.5	13.5	18	24	29	36.5	45	51

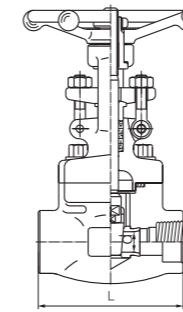

CL900-CL1500 Bolted bonnet, full port & reducing port outside screw and yoke (OS & Y)
threaded, butt-welded or socket welded ends; design to API 602

NPS	R.P	-	1/2	3/4	1	1 1/4	1 1/2	2	2 1/2	3
	F.P	1/4	3/8	1/2	3/4	1	1 1/4	1 1/2	2	2 1/2
L		92	111	111	120	120	140	178	180	-
D		8	10.5	13.5	18	24	29	36.5	45	-

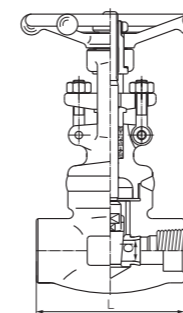

CL900-CL1500 Welded bonnet, full port & reducing port outside screw and yoke (OS & Y)
threaded, butt-welded or socket welded ends; design to API 602

NPS	R.P	-	1/2	3/4	1	1 1/4	1 1/2	2	2 1/2	3
	F.P	1/4	3/8	1/2	3/4	1	1 1/4	1 1/2	2	2 1/2
L		92	111	111	120	120	140	178	180	-
D		8	10.5	13.5	18	24	29	36.5	45	-

Female Threaded and Socket Welded Gate Valve CL1500–2500

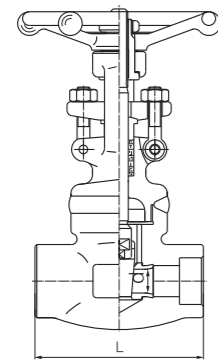

Applicable standards:

- Design and manufacture conform to :API602、BS5352、ANSI B16.34
- Connection ends conform to :
 - 1)Socket welded dimension conform ANSI B16.11
 - 2)Screw ends dimensin conform to ANSI B1.20.1
 - 3)Butt-welded conform to ANSI B16.25
 - 4)Flanged ends conform to ANSI B16.5
- Test and inspection conform to :API 598
- Structure features:
 - Bolted bonnet,outside screw and yoke
 - Welded bonnet,outside screw and yoke
- Materials conform to ANSI/ASTM
- Main materials:A105;LF2;F5;F11;F22;304(L);316(L); F347;F321;F51;Monel;20 Alloy.

CL2500

Welded bonnet,full port & reducing port outside screw and yoke(OS & Y)
Socket welded ends,design conform to ASME B 16.34

NPS	F.P	3 / 8	1 / 2	3 / 4	1	1 1/4
L		111	120	120	120	140
D		14	14	14	19	25

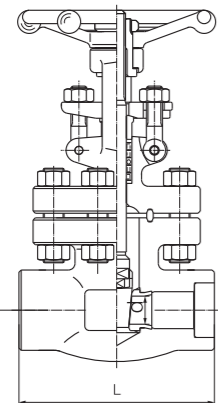

CL1500–CL2500

Welded bonnet,full port & reducing port outside screw and yoke(OS & Y)
Socket welded ends,design conform to ASME B 16.34

NPS	F.P		1 / 2	3 / 4	1	1 1/2	2
L		CL1500	111	150	150	210	235
		CL2500	125	150	210	235	235
D		CL1500	14	17	22	35	37
		CL2500	14	14	14	25	30

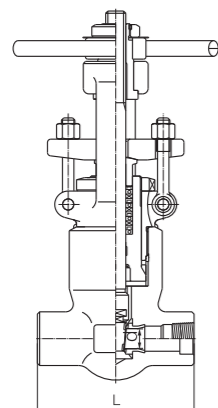

CL1500–CL2500

Welded bonnet,full port & reducing port outside screw and yoke(OS & Y)
Socket welded ends,design conform to ASME B 16.34

NPS	F.P		3 / 8	1 / 2	3 / 4	1	1 1/4	1 1/2	2
L		CL900–1500	140	140	140	140	178	178	216
		CL2500	186	186	186	186	232	232	279
D		CL900–1500	14	14	14	14	25	30	36.5
		CL2500	14	14	14	14	25	30	36.5

Female Threaded and Socket Welded Check Valve CL900–2500

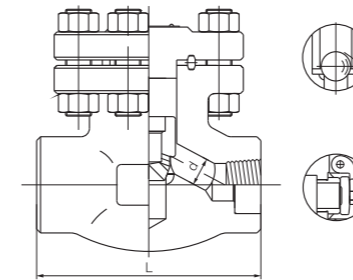

CL900–CL1500

Bolted bonnet,full port and reducing port
Threaded,butt-welded or socket welded ends;design to BS5352

NPS	F.P	1 / 4	3 / 8	1 / 2	3 / 4	1	1 1/4	1 1/2	2
L		110	110	110	110	150	150	210	235
D	Lift	9	10	12	15	20	28	32	40
	swing	8	10.5	13.5	18	24	29	36.5	45

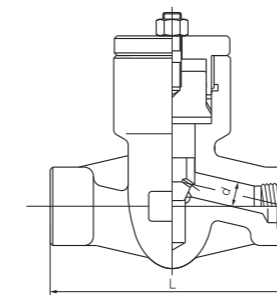

CL900–CL1500

Pressure seal bonnet,full port and reducing port
Threaded,butt-welded or socket welded ends;design to BS5352

NPS	R.P	-	1 / 2	3 / 4	1	1 1/4	1 1/2	2	2 1/2
	F.P	1 / 4	3 / 8	1 / 2	3 / 4	1	1 1/4	1 1/2	2
L			140	140	140	178	216	216	-
D			12	15	20	28	32	40	-

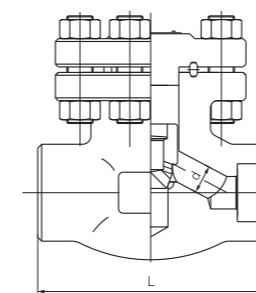

CL2500

Bolted bonnet,full port
Threaded,butt-welded or socket welded ends;design to ASME B16.34

NPS	F.P	1 / 4	3 / 8	1 / 2	3 / 4	1	1 1/4	1 1/2	2
L		150	150	150	150	210	235	235	235
D		7.5	10.5	11	14	19	25	28	35

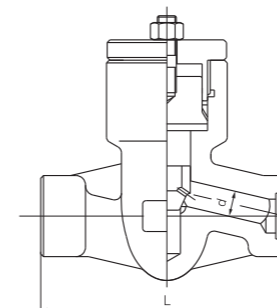

CL2500

Pressure seal bonnet,full port
Threaded,butt-welded or socket welded ends;design to ASME B16.34

NPS	F.P	1 / 4	3 / 8	1 / 2	3 / 4	1	1 1/4	1 1/2	2
L		-	-	186	186	186	232	232	279
D		-	-	11	14	19	25	28	35

Female Threaded and Socket Welded Check Valve CL800-1500

Applicable standards:

- Design and manufacture conform to :BS5352, MSS-SP-118
- Connection ends conform to :
 - 1)Socket welded dimension conform ANSI B16.11
 - 2)Screw ends dimension conform to ANSI B1.20.1
 - 3)Butt-welded conform to ANSI B16.25
 - 4)Flanged ends conform to ANSI B16.5
- Test and inspection conform to :API 598
- Structure features:
 - Gasket for bonnet connect acopmetal ring;
 - bolt bonnet,welded bonnet
- Materials conform to ANSI/ASTM
- Main materials:A105;LP2;F5;F11;F22;304(L);316(L);F347

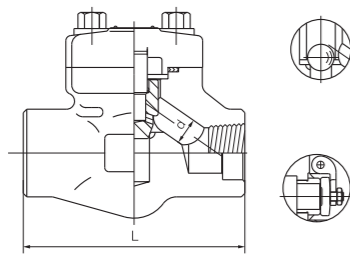

CL800 Bolted bonnet,full port and reducing port
Threaded,butt-welded or socket welded ends;design to BS5352

NPS	R.P	-	1/2	3/4	1	1 1/4	1 1/2	2	
	F.P	1/4	3/8	1/2	3/4	1	1 1/4	1 1/2	2
L	Lift	79	79	92	120	120	152	172	200
	swing	79	79	92	120	120	120	140	178
D	Lift	7	9	13	23	24	30	35	46
	swing	8	10.5	13.5	24	4.2	29	36.5	45

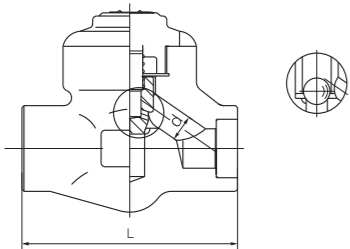

CL800 Welded bonnet,full port and reducing port
Threaded,butt-welded or socket welded ends;design to BS5352

NPS	R.P	-	1/2	3/4	1	1 1/4	1 1/2	2	2 1/2
	F.P	1/4	3/8	1/2	3/4	1	1 1/4	1 1/2	2
L		79	79	92	111	120	152	172	200
D		7	9	13	17.5	23	30	35	46

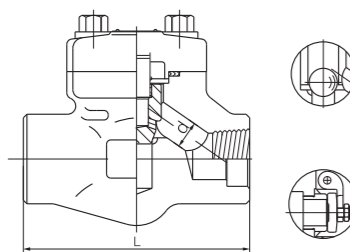

CL900-CL1500 Bolted bonnet,full port and reducing port
Threaded,butt-welded or socket welded ends;design to BS5352

NPS	R.P	-	1/2	3/4	1	1 1/4	1 1/2	2	
	F.P	1/4	3/8	1/2	3/4	1	1 1/4	1 1/2	2
L	Lift	92	111	111	120	152	172	200	-
	swing	92	111	111	120	120	140	178	-
D	Lift	7	12	15	20	23	32	40	-
	swing	8	10.5	13.5	18	24	29	45	-

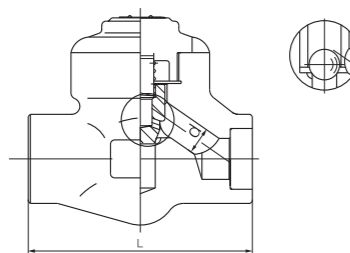

CL900-CL1500 Welded bonnet,full port and reducing port
Threaded,butt-welded or socket welded ends;design to BS5352

NPS	R.P	-	1/2	3/4	1	1 1/4	1 1/2	2	
	F.P	1/4	3/8	1/2	3/4	1	1 1/4	1 1/2	2
L		92	111	111	120	152	172	200	
D		7	12	15	20	28	32	40	

Forged Steel Flange Gate Valve CL150-2500

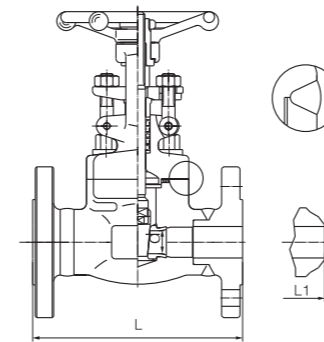

CL150-300-600

Bolted bonnet, reducing port outside screw and yoke (os & Y)
Flange-or butt-welded ends; design to API 602 BS5352

NPS		1/4	3/8	1/2	3/4	1	1 1/4	1 1/2	2	2 1/2
F.P	L(RH) L1(BW)	-	-	108	117	127	140	165	178	190
		-	-	140	152	165	178	190	216	241
		-	-	165	190	216	229	241	292	330
D		-	-	10	13.5	18	24	29	36.5	45

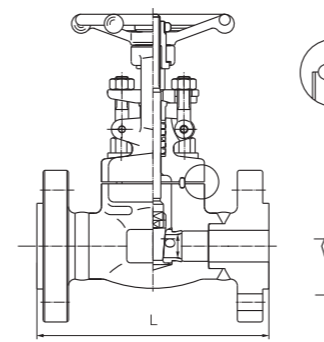

CL900-CL1500

Bolted bonnet, Full port outside screw and yoke (os & Y)
Flange-welded or butt-welded ends; design to BS5352

NPS		1/4	3/8	1/2	3/4	1	1 1/4	1 1/2	2
F.P	L(RH),L1(BW)	-	-	216	229	254	279	305	368
	L (RTJ)	-	-	216	229	254	279	305	371
D		-	-	13.5	18	24	29	36.5	45

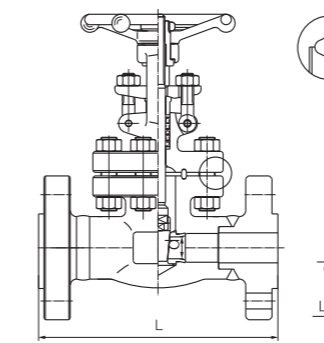

CL2500

Bolted bonnet, Full port outside screw and yoke (os & Y)
Flange-welded or butt-welded ends; design to ASME B16.34

NPS		1/4	3/8	1/2	3/4	1	1 1/4	1 1/2	2
F.P	L(RH),L1(BW)	-	-	264	273	308	-	384	451
	L (RTJ)	-	-	264	273	308	-	387	454
D		-	-	13.5	13.5	19	-	30	36.5

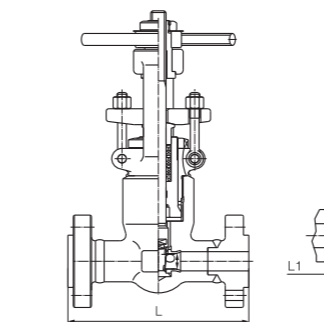

CL2500

Pressure seal gate valves, Full port outside screw and yoke (os & Y)
Flange-welded or butt-welded ends; design to ASME B16.34

NPS		1/4	3/8	1/2	3/4	1	1 1/4	1 1/2	2
F.P	L(RH),L1(BW)	-	-	264	273	308	-	384	451
	L (RTJ)	-	-	264	273	308	-	387	454
D		-	-	13.5	13.5	19	-	30	36.5

Bellow Sealed Globe Valve CL800-1500

Applicable standards:

- Design and manufacture conform to :API602、 MSS-SP-117
- Connection ends conform to :
 - 1)Socket welded dimension conform ANSI B16.11
 - 2)Screw ends dimension conform to ANSI B1.20.1
 - 3)Butt-welded conform to ANSI B16.25
 - 4)Flanged ends conform to ANSI B16.5
- Test and inspection conform to :API 598
- Structure features:
 - Bolted bonnet,outside screw and yoke
 - Welded bonnet,outside screw and yoke
 - Materials conform to ANSI/ASTM
 - Main materials:A105;304(L);316(L);F347;F321
 - Bellow materials:304、 321、 316、 Inconel 625,hastelloy,C 276,Monel

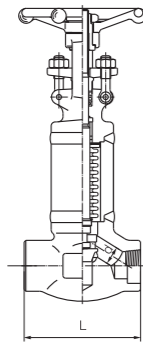

CL800 Welded bonnet,full port & reducing port outside screw and yoke(OS & Y)
 Threaded,butt-welded or socket welded ends;design to BS5352/MSS-SP-117

NPS	R.P	-	1/2	3/4	1	1 1/4	1 1/2	2	2 1/2
	F.P	1/4	3/8	1/2	3/4	1	1 1/4	1 1/2	2
L		79	79	92	111	120	152	172	200
D		7.0	9.0	13	17.5	23	30	35	46

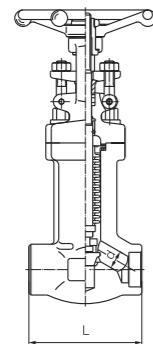

CL800 Bolted bonnet,full port & reducing port outside screw and yoke(OS & Y)
 Threaded,butt-welded or socket welded ends;design to BS5352/MSS-SP-117

NPS	R.P	-	1/2	3/4	1	1 1/4	1 1/2	2	2 1/2
	F.P	1/4	3/8	1/2	3/4	1	1 1/4	1 1/2	2
L		79	79	92	111	120	152	172	200
D		7.0	9.0	13	17.5	23	30	35	46

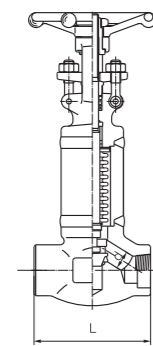

CL1500 Welded bonnet,full port & reducing port outside screw and yoke(OS & Y)
 Threaded,butt-welded or socket welded ends;design to BS5352/MSS-SP-117

NPS	F.P	1/4	3/8	1/2	3/4	1	1 1/4	1 1/2	2
	L		92	92	111	111	120	152	172
D		7	9	12	15	20	28	32	40

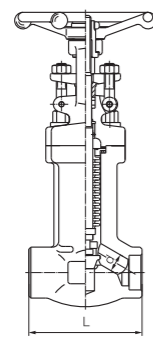

CL1500 Bolted bonnet,full port outside screw and yoke(OS & Y)
 Threaded,butt-welded or socket welded ends;design to BS5352/MSS-SP-117

NPS	F.P	1/4	3/8	1/2	3/4	1	1 1/4	1 1/2	2
	L		92	92	111	111	120	152	172
D		7	9	12	15	20	28	32	40

Short Pattern Bellow Seal Globe Valve CL800

Applicable standards:

- Design and manufacture conform to :BS5352、 MSS-SP-117
- Connection ends conform to :
 - 1)Socket welded dimension conform ANSI B16.11
 - 2)Screw ends dimension conform to ANSI B1.20.1
 - 3)Butt-welded conform to ANSI B16.25
 - 4)Flanged ends conform to ANSI B16.5
- Test and inspection conform to :API 598
- Structure features:
 - Bolted bonnet,outside screw and yoke
 - Welded bonnet,outside screw and yoke
 - Materials conform to ANSI/ASTM
 - Main materials:A105;LF2;F5;F11;F22;304(L);316(L); F347;F321;F51;Monel;20 Alloy.
 - Bellow materials:304,321,316,Inconel 625,hastelloy,C 276,Monel

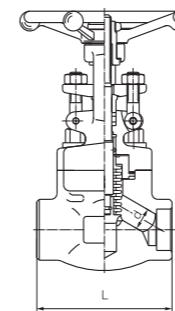

CL800 Bolted bonnet,full port & reducing port outside screw and yoke(OS & Y)
 Threaded,butt-welded or socket welded ends;design to BS5352/MSS-SP-117

NPS	R.P	-	1/2	3/4	1	1 1/4	1 1/2	2	2 1/2
	F.P	1/4	3/8	1/2	3/4	1	1 1/4	1 1/2	2
L		79	79	92	111	120	152	170	200
D		7.0	9.0	13	17.5	23	30	35	46

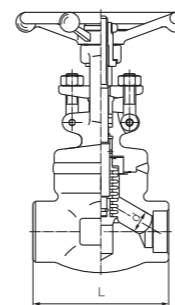

CL800 Welded bonnet,full port & reducing port outside screw and yoke(OS & Y)
 Threaded,butt-welded or socket welded ends;design to BS5352、 MSS-SP-117

NPS	R.P	-	1/2	3/4	1	1 1/4	1 1/2	2	2 1/2
	F.P	1/4	3/8	1/2	3/4	1	1 1/4	1 1/2	2
L		79	79	92	111	120	152	170	200
D		7.0	9.0	13	17.5	23	30	35	46

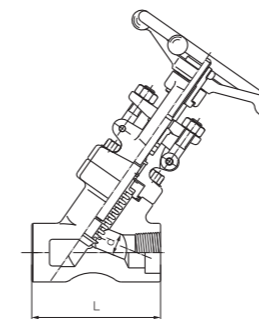

CL800 Bolted bonnet,full port & reducing port outside screw and yoke(OS & Y)
 Threaded,butt-welded or socket welded ends;design to BS5352、 MSS-SP-117

NPS	R.P	-	1/2	3/4	1	1 1/4	1 1/2	2	2 1/2
	F.P	1/4	3/8	1/2	3/4	1	1 1/4	1 1/2	2
L		98	98	98	111	140	140	155	170
D		7	9	13	17.5	23	30	35	46

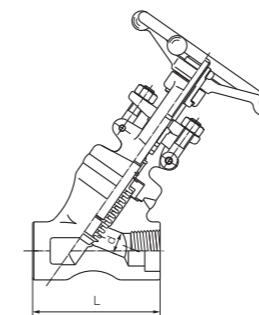

CL800 Welded bonnet,full port & reducing port outside screw and yoke(OS & Y)
 Threaded,butt-welded or socket welded ends;design to BS5352、 MSS-SP-117

NPS	R.P	-	1/2	3/4	1	1 1/4	1 1/2	2	2 1/2
	F.P	1/4	3/8	1/2	3/4	1	1 1/4	1 1/2	2
L		79	79	92	100	140	140	155	170
D		7	9	13	17.5	23	30	35	46

Flange and Butt- Welded Globe Valve CL150-2500

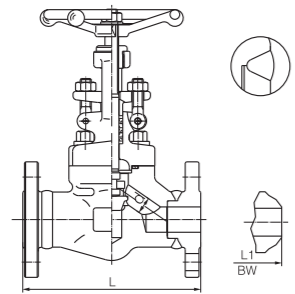

CL150-300-600

Bolted bonnet, reducing port outside screw and yoke (OS & Y)
Flange or butt-welding design to BS5352

NPS	F.P	1/4	3/8	1/2	3/4	1	1 1/4	1 1/2	2
L(RF) L1(BW)	-	-	108	117	127	140	165	203	
	-	-	152	178	203	216	229	267	
	-	-	165	190	216	229	241	292	
D	-	-	9	13	17.5	23	30	35	

Flange Integrity forged steel valve enquiry please contact sales department.

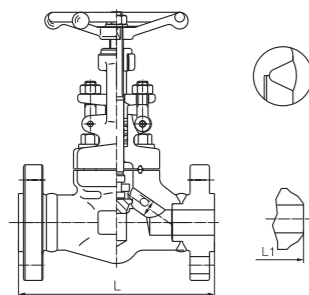

CL900-CL1500

Bolted bonnet, full port outside screw and yoke (OS & Y)
Flange or butt-welding design to BS5352

(NPS)	F.P	1/4	3/8	1/2	3/4	1	1 1/4	1 1/2	2
L(RF), L1(BW)	-	-	216	229	254	279	305	368	
	-	-	216	229	254	279	305	371	
	-	-	12	15	20	28	32	40	
D	-	-	12	15	20	28	32	40	

Flange Integrity forged steel valve enquiry please contact sales department.

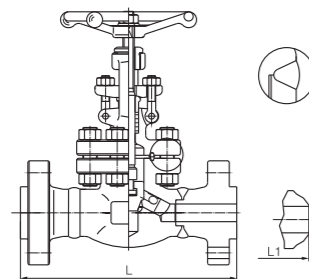

CL2500

Bolted bonnet, full port outside screw and yoke (OS & Y)
Flange or butt-welded design conform to ASME B16.34

(NPS)	F.P	1/4	3/8	1/2	3/4	1	1 1/4	1 1/2	2
L(RF), L1(BW)	-	-	264	273	308	-	384	451	
	-	-	264	273	308	-	387	454	
	-	-	11	14	19	-	28	35	
D	-	-	11	14	19	-	28	35	

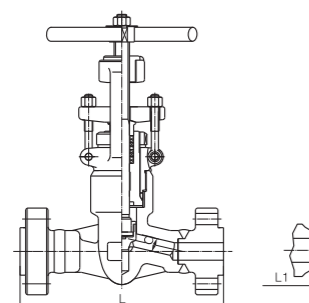

CL2500

Pressure seal bonnet, full port outside screw and yoke (OS & Y)
Flange or butt-welded design conform to ASME B16.34

(NPS)	F.P	1/4	3/8	1/2	3/4	1	1 1/4	1 1/2	2
L(RF), L1(BW)	-	-	264	273	308	349	384	451	
	-	-	264	273	308	349	387	454	
	-	-	11	14	19	25	28	35	
D	-	-	11	14	19	25	28	35	

Bellow Sealed Globe Valve CL150-1500

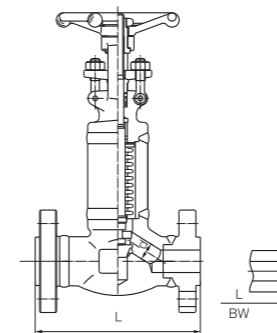

CL150-300-600

Welded bonnet, reducing port outside screw and yoke (OS & Y)
Flange or butt-welded ends; design to BS5352/MSS-SP-117

NPS	R.P	1/4	3/8	1/2	3/4	1	1 1/4	1 1/2	2
L(RF) L1(BW)	-	-	108	117	127	140	165	203	
	-	-	152	178	203	216	229	267	
	-	-	165	190	216	229	241	292	
D	-	-	9	13	17.5	23	30	35	

Flange Integrity forged steel valve enquiry please contact sales department.

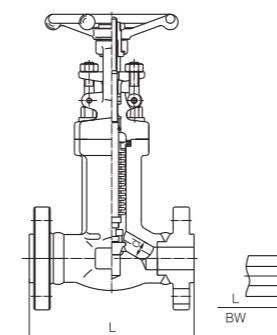

CL150-300-600

Bolted bonnet, reducing port outside screw and yoke (OS & Y)
Flange or butt-welded ends; design to BS5352/MSS-SP-117

NPS	R.P	1/4	3/8	1/2	3/4	1	1 1/4	1 1/2	2
L(RF) L1(BW)	-	-	108	117	127	140	165	203	
	-	-	152	178	203	216	229	267	
	-	-	165	190	216	229	241	292	
D	-	-	9	13	17.5	23	30	35	

Flange Integrity forged steel valve enquiry please contact sales department.

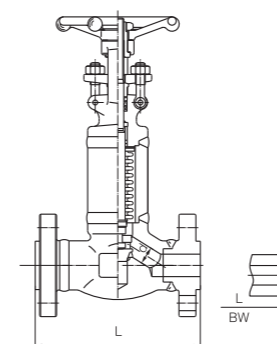

CL1500

Welded bonnet, full port outside screw and yoke (OS & Y)
Flange or butt-welded ends; design to BS5352/MSS-SP-117

NPS	F.P	1/4	3/8	1/2	3/4	1	1 1/4	1 1/2	2
L	-	-	216	229	254	280	305	368	
	-	-	216	229	254	280	305	371	
	-	-	12	15	20	28	32	40	
D	-	-	12	15	20	28	32	40	

Flange Integrity forged steel valve enquiry please contact sales department.

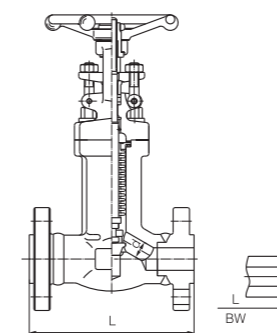

CL1500

Bolted bonnet, full port outside screw and yoke (OS & Y)
Flange or butt-welded ends; design to BS5352/MSS-SP-117

NPS	F.P	1/4	3/8	1/2	3/4	1	1 1/4	1 1/2	2
L(RF), L1(BW)	-	-	216	229	254	280	305	368	
	-	-	216	229	254	280	305	371	
	-	-	12	15	20	28	32	40	
D	-	-	12	15	20	28	32	40	

Flange Integrity forged steel valve enquiry please contact sales department.

Y Type Globe Valve CL800–1500

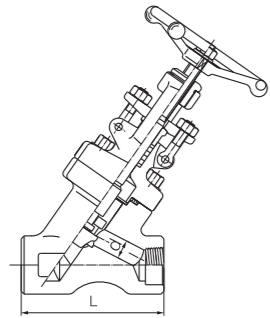

CL800

Bolted bonnet, full port & reducing port outside screw and yoke (OS & Y) threaded, butt-welded or socket welded ends; design to BS5352

NPS	R.P	-	1/2	3/4	1	1 1/4	1 1/2	2	2 1/2	3
	F.P	1/4	3/8	1/2	3/4	1	1 1/4	1 1/2	2	2 1/2
L		98	98	98	111	140	140	155	170	-
D		7	9	13	17.5	23	30	35	46	-

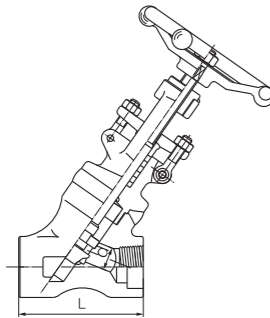

CL800

Welded bonnet, full port & reducing port outside screw and yoke (OS & Y) threaded, butt-welded or socket welded ends; design to BS5352

NPS	R.P	-	1/2	3/4	1	1 1/4	1 1/2	2	2 1/2	3
	F.P	1/4	3/8	1/2	3/4	1	1 1/4	1 1/2	2	2 1/2
L		79	79	92	100	140	140	155	170	-
D		7	9	13	17.5	23	30	35	46	-

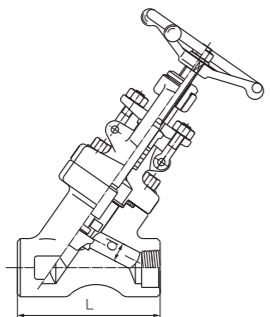

CL900–CL1500

Bolted bonnet, full port & outside screw and yoke (OS & Y) threaded, butt-welded or socket welded ends; design to BS5352

NPS	F.P	3/8	1/2	3/4	1	1 1/4	1 1/2	2	2 1/2
	L		98	111	111	140	140	155	170
D		9	12	15	20	28	32	40	-

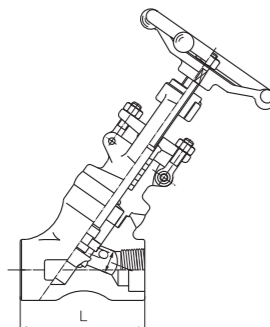

CL900–CL1500

Welded bonnet, full port & outside screw and yoke (OS & Y) threaded, butt-welded or socket welded ends; design to BS5352

NPS	F.P	3/8	1/2	3/4	1	1 1/4	1 1/2	2	2 1/2
	L		92	100	100	140	140	155	170
D		9	12	15	20	28	32	40	-

Female Threaded and Socket Welded Globe Valve CL900–2500

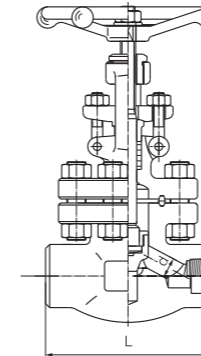

CL900–CL1500

Bolted bonnet, full port outside screw and yoke (OS & Y) threaded, butt-welded or socket welded ends; design to BS5352

NPS	1/2	3/4	1	1 1/4	2	2 1/2	
	F.P	L	110	110	150	150	210
	D	9	12	15	20	32	40

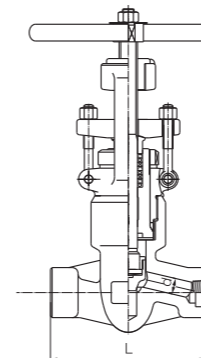

CL900–CL1500

Pressure seal bonnet, full port outside screw and yoke (OS & Y) threaded, butt-welded or socket welded ends; design to BS5352

NPS	1/2	3/4	1	1 1/4	1 1/2	2	2 1/2	
	F.P	L	110	110	110	178	178	210
	D	12	15	20	28	32	40	-

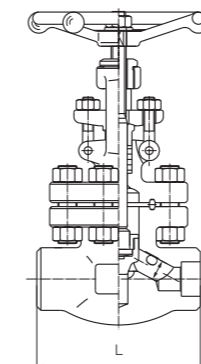

CL2500

Bolted bonnet, full port outside screw and yoke (OS & Y) socket welded ends; design conform to ASME B16.34

NPS	1/2	3/4	1	1 1/4	1 1/2	2	2 1/2	
	F.P	L	150	150	210	-	235	235
	D	11	14	19	-	28	35	-

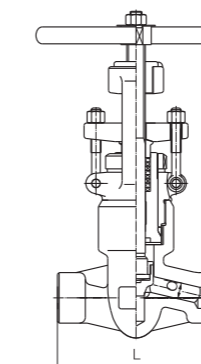

CL2500

Pressure seal bonnet, full port outside screw and yoke (OS & Y) socket welded ends; design conform to ASME B16.34

NPS	1/2	3/4	1	1 1/4	1 1/2	2	2 1/2	
	F.P	L	186	186	186	232	232	279
	D	11	14	19	25	28	35	-

Y Type Globe Valve CL800-4500

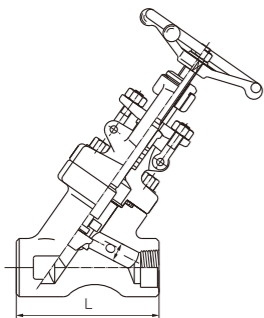

CL800

Bolted bonnet, full port & reducing port outside screw and yoke (OS & Y) threaded, butt-welded or socket welded ends; design to BS5352

NPS	R.P	-	1/2	3/4	1	1 1/4	1 1/2	2	2 1/2	3
	F.P	1/4	3/8	1/2	3/4	1	1 1/4	1 1/2	2	2 1/2
L		98	98	98	111	140	140	155	170	-
D		7	9	13	17.5	23	30	35	46	-

Y Type Globe Valve CL1690-CL4500

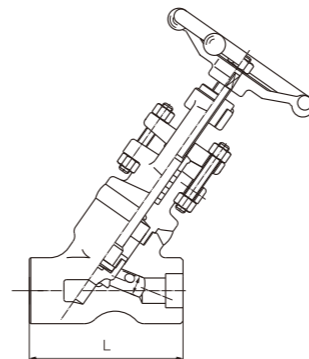

CL2500

Welded bonnet, full port outside screw and yoke (OS & Y) Socket welded, design conform to ASME16.34

NPS	F.P	3/8	1/2	3/4	1	1 1/4	1 1/2	2	2 1/2
L		186	186	186	186	232	232	310	
D		9	11	14	19	25	28	35	

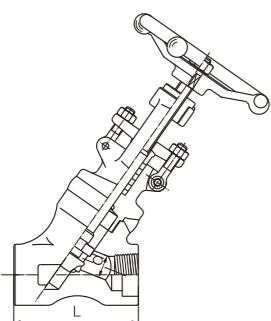

CL800

Welded bonnet, full port & reducing port outside screw and yoke (OS & Y) threaded, butt-welded or socket welded ends; design to BS5352

NPS	R.P	-	1/2	3/4	1	1 1/4	1 1/2	2	2 1/2	3
	F.P	1/4	3/8	1/2	3/4	1	1 1/4	1 1/2	2	2 1/2
L		79	79	92	100	140	140	155	170	
D		7	9	13	17.5	23	30	35	46	

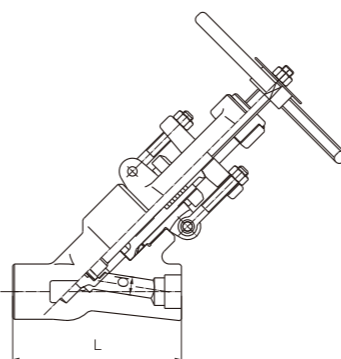

CL2500

Pressure seal bonnet, full port outside screw and yoke (OS & Y) Socket welded, design conform to ASME16.34

NPS	F.P	3/8	1/2	3/4	1	1 1/4	1 1/2	2	2 1/2
L		186	186	186	186	232	232	310	
D		9	11	14	19	25	28	35	

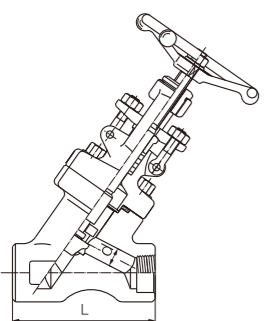

CL900-CL1500

Bolted bonnet, full port & outside screw and yoke (OS & Y) threaded, butt-welded or socket welded ends; design to BS5352

NPS	F.P	3/8	1/2	3/4	1	1 1/4	1 1/2	2	2 1/2
L		98	111	111	140	140	155	170	
D		9	12	15	20	28	32	40	

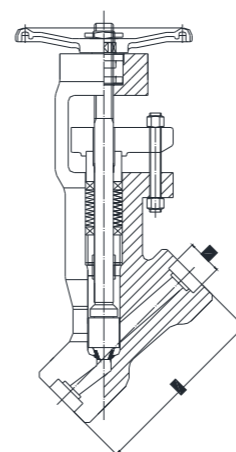

GLOBE VALVE CLASS 1690 4225 PSI@100°F(291.3BAR@38°C)
GLOBE VALVE CLASS 2680 6700 PSI@100°F(461.9 BAR@38°C)

NPS	F.P	3/8	1/2	3/4	1	1 1/4	1 1/2	2	2 1/2
L		134	134	134	134		257	257	
D		21.8	21.8	27.1	33.8		48.7	61.2	

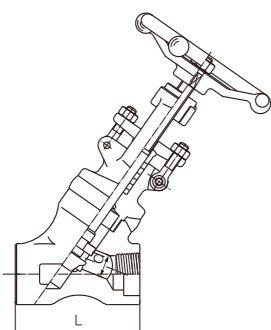

CL900-CL1500

Welded bonnet, full port & outside screw and yoke (OS & Y) threaded, butt-welded or socket welded ends; design to BS5352

NPS	F.P	3/8	1/2	3/4	1	1 1/4	1 1/2	2	2 1/2
L		92	100	100	140	140	155	170	
D		9	12	15	20	28	32	40	

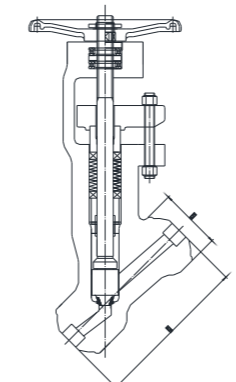

GLOBE VALVE CLASS 1690 4225 PSI@100°F(291.3BAR@38°C)
GLOBE VALVE CLASS 2680 6700 PSI@100°F(461.9 BAR@38°C)

NPS	F.P	3/8	1/2	3/4	1	1 1/4	1 1/2	2	2 1/2
L		134	134	134	134		257	257	
D		58	58	58	58		102	102	

Cryogenic Globe Valve CL800–1500

Applicable standards:

- Design and manufacture conform to :API 602 Bs5352 ANSI B16.34
- Connection ends conform to :
 - 1)Socket welded dimension conform ANSI B16.11
 - 2)Screw ends dimension conform to ANSI B1.20.1
 - 3)Butt-welded conform to ANSI B16.25
 - 4)Flanged ends conform to ANSI B16.5

- Test and inspection conform to :API 598
- Structure features:
 - Bolted bonnet/outside screw and yoke welded bonnet,outside screw and yoke
- Materials conform to ANSI/ASTM
- Main materials:LF2;LF3;304(L);316(L);F347;F321;F51;Monel;20 Alloy.

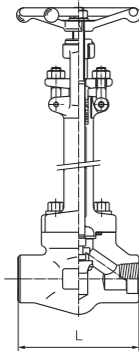

CL800

Bolted bonnet cryogenic extended bonnet full port & reduced port,(OS & Y)
Threaded or socket welded ends;design to Bs5352

NPS	R.P	-	1/2	3/4	1	1 1/4	1 1/2	2	2 1/2
	F.P	1/4	3/8	1/2	3/4	1	1 1/4	1 1/2	2
L		79	79	92	111	120	152	170	200
D		7.0	9.0	13	17.5	23	30	35	46

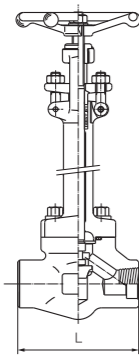

CL1500

Bolted bonnet cryogenic extended bonnet full port & reduced port,(OS & Y)
Threaded or socket welded ends;design to BS5352

NPS	R.P	-	1/2	3/4	1	1 1/4	1 1/2	2	2 1/2
	F.P	1/4	3/8	1/2	3/4	1	1 1/4	1 1/2	2
L		92	111	111	120	152	172	200	
D		9	12	15	20	28	32	40	

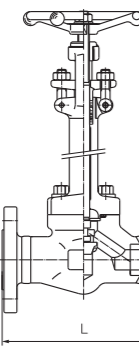

CL150–300–600

Bolted bonnet cryogenic extended bonnet ,reduced port,(OS & Y)
Flanged or butt welded ends;design to BS5352

NPS	R.P	1/4	3/8	1/2	3/4	1	1 1/4	1 1/2	2
L(RF) L1(BW)		-	-	108	118	127	-	165	203
		-	-	153	178	203	-	229	267
		-	-	165	191	216	-	241	292
D		-	-	9.0	13	17.5	-	30	35

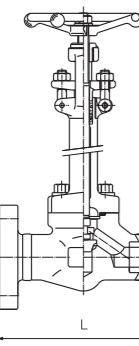

CL1500

Bolted bonnet cryogenic extended bonnet ,full port,(OS & Y)
Flanged or butt welded ends;design to BS5352

NPS	F.P	1/4	3/8	1/2	3/4	1	1 1/4	1 1/2	2
L		-	-	216	229	254	280	305	366
D		-	-	12	15	20	28	32	40

Flange Integrity forged steel valve enquiry please contact sales department.

DIN Cast Steel Globe Valve PN25–160

Applicable standards:

- DESIGN AND MANUFACTURE :EN13709
- INSPECTION AND TEST:ISO5208、EN 12266
- FLANGED ENDS DIMENSIONS:EN 1092-1、DIN2544 PN25、DIN2545 PN40、DIN2546 PN64
- BUTT-WELDED ENDS DIMENSION:EN12627
- FACE TO FACE AND END TO END:DIN 3202、EN558-1、ISO5752
- PRESSURE-TEMPERATURE RATINGS:DIN 2401

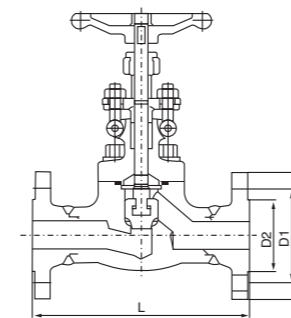

PN25

DN	15	20	25	32	40	50
L	130	150	160	180	200	230
D	95	105	115	140	150	165
D1	65	75	85	100	110	125
D2	45	58	68	78	88	102

PN40

DN	15	20	25	32	40	50
L	130	150	160	180	200	230
D	95	105	115	140	150	165
D1	65	75	85	100	110	125
D2	45	58	68	78	88	102

PN64

DN	15	20	25	32	40	50
L	210	230	230	260	260	300
D	105	130	140	155	170	180
D1	75	90	100	110	125	135
D2	45	52	68	75	88	102

Applicable standards:

- DESIGN AND MANUFACTURE :EN13709
- INSPECTION AND TEST:ISO5208、EN 12266
- FLANGED ENDS DIMENSIONS:EN 1092-1、DIN2544 PN25、DIN2545 PN40、DIN2546 PN64
- BUTT-WELDED ENDS DIMENSION:EN12627
- FACE TO FACE AND END TO END:DIN 3202、EN558-1、ISO5752
- PRESSURE-TEMPERATURE RATINGS:DIN 2401

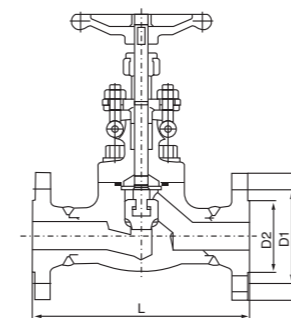

PN100

DN	15	20	25	32	40	50
L	210	230	230	260	260	300
D	105	130	140	155	170	195
D1	75	90	100	110	125	145
D2	45	52	68	75	88	102

PN160

DN	15	20	25	32	40	50
L	210	230	230	260	260	300
D	105	130	140	155	170	195
D1	75	90	100	110	125	145
D2	45	52	68	75	88	102